

keyto

TR116H

Portable Expandable Multiscreen

User Manual



Fully portable, easy to assemble



www.menastoretd.com

PRODUCT INTRODUCTION



Interface Button

1. Type-C data interface: connect to the laptop TYPE-C data interface
2. Mini HDMI interface: connect to the laptop Mini HD interface
3. Type-C power interface: supporting (5V-20V) PD protocol



Buttons

1. 1/4 Screen off key
2. 3/6 Screen brightness-
3. 2/5 Screen dimmed button



- | | |
|----------------------|----------------------|
| ① Screen off key | ④ Screen off key |
| ② Screen brightness- | ⑤ Screen brightness- |
| ③ Screen brightness+ | ⑥ Screen brightness+ |

ROTATE ANGLES

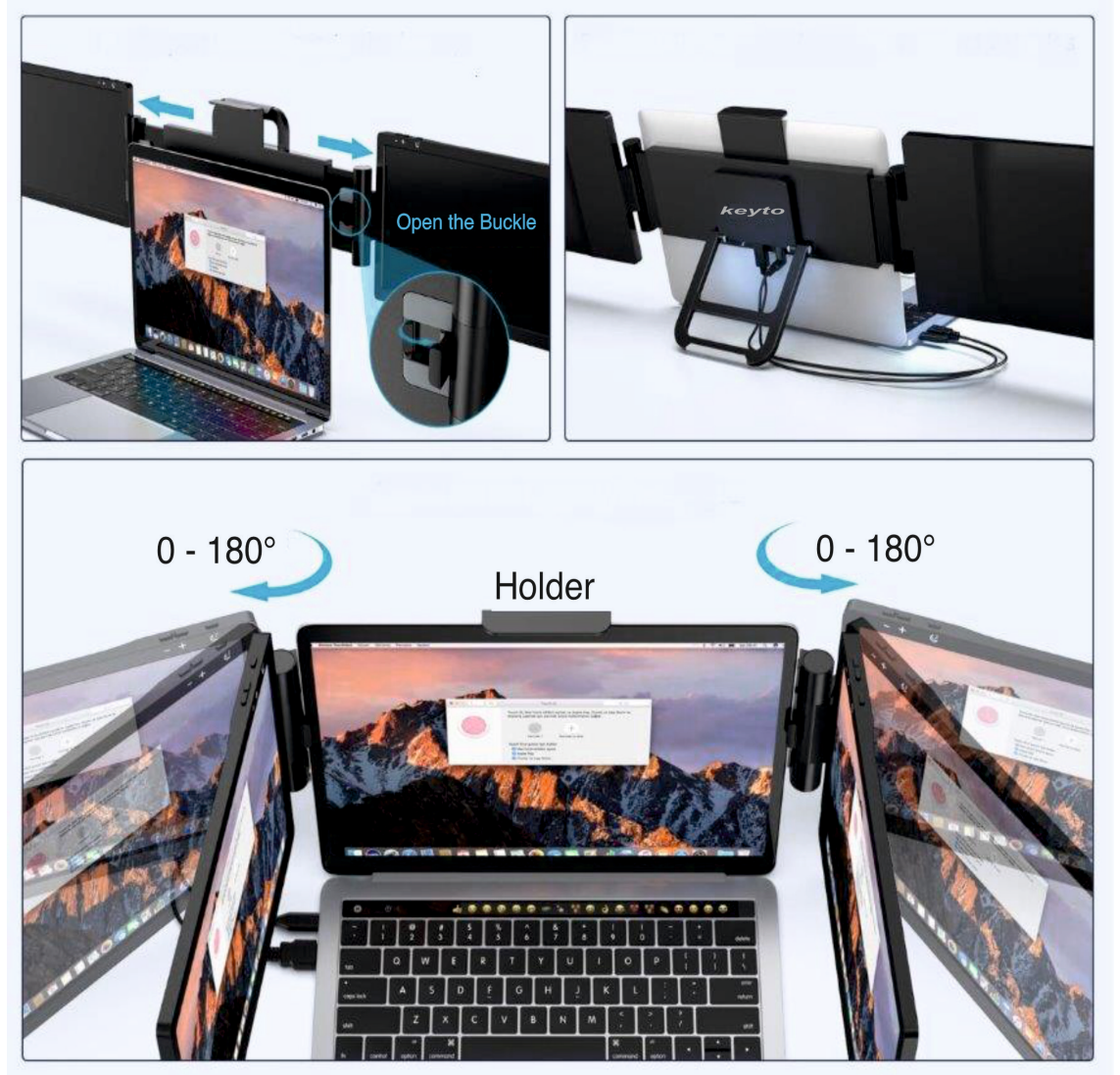

TECHNICAL SPECIFICATIONS

- Screen: 11.6" LCD IPS screen * 2
- Resolution: 1366RGB*768
- Button: Screen sleep key, screen brightness key +.Screen brightness key –
- Interface: Type-c*2(Computer USB-C interface*1, PD power supply interface*1); mini HDMI*1
- Display area: 256.125(H)x144.00(V) (mm)
- Backlight type: W-LED backlight
- Brightness: LCM brightness (center): 200cd/m2 (min), 220cd/m2 (max) contrast
- Pixel pitch: 0.1875(H)×0.1875(V)
- Angle of view: Measure the viewing angle at the center point of the LCD by CONOSCOPE (ergo-80)
- Display the number of colors: 16.7M
- Screen ratio: 16 : 9 (wide screen)
- Refresh rate: 60hz
- Color rhyme: 45% NTSC
- Video output: USB2.0, USB3.0, TYPE C, TYPE A, Thunderbolt, Mini-HD
- Power input: 5V-20V PD input (supplied through Type-c)
- Device size: Length 319.99mm*width172.55mm*height 42.2mm
- Device weight: 1.1 KG

“What is in the box”

Monitor * 1, USB-C cable*1 USB-A*1 ,mini-HDMI-HDMI*1,Type-C-miniHDMI*1

The **minimum** distance the bracket can be stretched from left to right is 26.5 cm



The **maximum** distance the bracket can be stretched from left to right is 36.5 cm cm

PRODUCT WARNING

Please operate the dual-screen monitor carefully, avoid pressing with your fingers or hard objects on the screen. Do not rotate excessively.
Rotate screen angle allowed (0° - 180°)

Left screen (0° - 180°)

Right screen (0° - 180°)



PRODUCT INFORMATION

The order of turning on the device is to open screen 2 first, then open screen 1. Closing the device, you must first close screen 1 and then close screen 2.

(Note: Do not touch the display with your hands, it is recommended to unfold and close the device from the middle position)

Using a TYPE-C data cable and an HD-mini cable to connect to a computer or laptop can support 2 extended display screens at the same time; only 2 cables will make it work so it reduces the messy troubles caused by multi-line connections to users and consumers.

1. The laptop is connected to the computer through the Type-c interface. If there is no Type-C interface or the Type-c interface cannot be used, it connects the Type-C interface of the device through the USB 3.0 interface of the computer.
2. Please ensure that the computer system is win10 or win11. If the device displays no signal, please check and update win10, win11 system.
3. The MAC system needs the Intel System. You will need one USB-C thunder-bolt port and one mini-HDMI cable connection.
4. Compatible with various operating systems such as WINDOWS, MAC, Andriod with the thunder bolt interface to meet the needs of users for multi-screen synchronization extending screens.

PRODUCT SETUP STEPS

1. Open the monitor in the direction shown in the figure below.(Note: Do not touch the monitor with your hands, it is recommended to unfold and close the device from the middle position).
2. Pull the screen in the direction to the same width as the laptop monitor, and then buckle it on the laptop through the buckle in the middle of the device.
3. There is a bearing gravity bracket on the back of the tri-screen monitor, which can be adjusted according to the angle you need when using it.
4. Use the corresponding cable to connect the tri-screen monitor and the laptop. (For the corresponding ports of the tri-screen monitor, please refer to the "Interfaces and buttons" in this manual).

INSTRUCTIONS

1. To use the monitors, first determine the type of connector you have on your laptop. As shown below
2. If your laptop has two Type-c ports, please use the Type-c data cable that comes with the dual-screen display to connect.
3. If your laptop does not have a "Type-c" interface, you will need to use a USB-C data cable to connect to the USB 3.0 port of the laptop. If the device displays abnormalities, it means that the power supply of the USB 3.0 port of the laptop is insufficient, and you need to use a Type-c power supply Connect to the power interface of the device for power supply.

USB 3.0 Interface



Type C Interface

Adjust the screen display settings in the notebook settings, select the same screen display or split screen display.

COMPUTER SETTINGS

WINDOWS

1. Enter Display Settings (Start Settings System Display)
2. Click and drag the screen
3. If you need to set different display modes for multiple screens, please click V1/2/3 (click the "Identification" button at the bottom of the screen to know the corresponding screen) and select the corresponding display, then go to the "Multiple Display Settings" menu to configure Set accordingly. (*Please go to the graphics card to set up three screens at the same time
4. If the screen is upside down, please click the screen, and "Display Orientation" in "Scale and Layout" and adjust it in the drop-down menu.

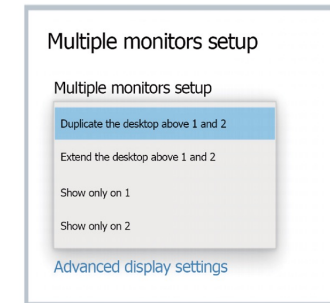
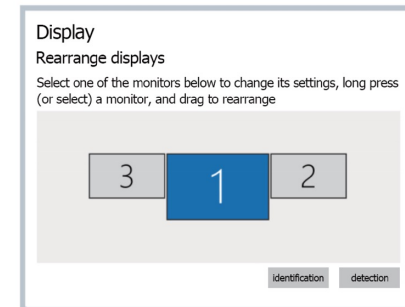

MAC

1. Open System Preferences
2. Select Displays from the menu
3. Click Arrangement under Display settings
4. Click on the screen to drag and adjust the position
5. If there is an inverted screen, you can adjust the angle in the "Display" menu
6. If you want to zoom, you can select zoom under the "Display" setting and adjust it
7. Check the "Mirrored Display" at the bottom of the screen to display three screens at the same time